



## **Rheology Solutions**

*Rheology Solutions is the sole Australian distributor of this product range and we welcome the opportunity of discussing your application requirements.*

*We hope the information you are seeking is contained within this file.  
If you have any questions, or require further information please contact us.  
We look forward to being of further service.*

*Regards from the Team at Rheology Solutions.*

**RHEOLOGY SOLUTIONS PTY LTD.** ACN 082 479 632

**HEAD OFFICE:** 15-19 Hillside Street, Bacchus Marsh, Victoria 3340 Australia. PO Box 754, Bacchus Marsh, Victoria 3340 Australia.  
**Telephone:** +61 3 5367 7477 **Facsimile:** +61 3 5367 6477 **Email:** [info@rheologysolutions.com](mailto:info@rheologysolutions.com) **Website:** [www.rheologysolutions.com](http://www.rheologysolutions.com)

## Mortar Probe V0011

Mortar probe made of hardened stainless steel. This is used for mortar with a maximum particle size of 2 mm . Using of a scraper is recommended for this probe.  
Weight 41g



## Cement Paste Probe V0013

Cement paste probe made of stainless steel. This probe is used for cement paste and mortar with a maximum particle size of 0.5 mm.



## Modified Cement Paste Probe V0003

formed like the standard cement-paste-probe, but for suspension up to 2 mm of max. grain diameter. Built in temperature sensor RTD PT100 1/3 DIN B



## Scraper V0021

Scraper made of hardened stainless steel. Strongly recommended for mortar.



## Cylinder Probe V0070

Cylindrical formed test probe for the Viskomat NT. Including beaker, and probe. Couette system according to DIN 53019. diameter 50mm, bottom cone formed,  $\Delta = R_{outer}/R_{inner} = 1.0847$ , gap size 2.12 mm, specimen volume 127.7 ml. Beaker height 150mm, At 100 rpm and 200 Nmm: shear rate 129.08



1/s, shear stress 570.4 Pa, viscosity 4.42 Pa\*s. Including RTD for temperature measurement.

Net weight 2.3 kg

## Cone Plate Probe V0002

specially developed for glue like specimen. Fits best for speeds between 0 and 0.5 rpm. Diameter of the cone: 100 mm



## Basket Probe V0014

invented by Prof. R. Vogel, Weimar. Double gap system with a net formed surface. Specially

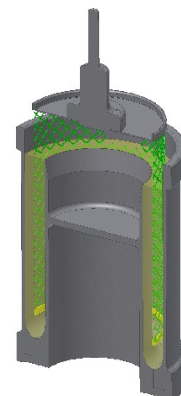

developed for self compacting mortars. Including special vessel and calibration certifi-caten

## Ball-Probe-System V0007

With three spheres 10mm, 20mm und 30mm diameter. Special vessel 140mm diameter, inner height 80mm.

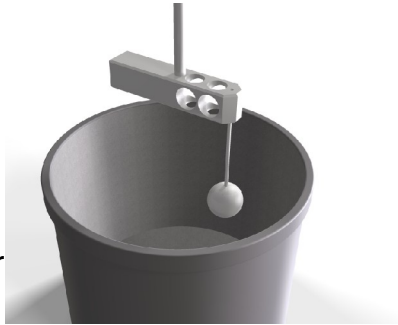

Probe and vessel made of stainless steel.

## Vane-Probe V0004 with Special Vessel V0005

Probe with 6 wings, diameter 40mm, height 60 mm. Vessel with inner diameter of 100mm, inner height 110 mm. Incl. Temperature sensor.



## Beaker for Temperature Control V0009

A double wall beaker, so that the measurement beaker is running in a water bath, which was circulated by an



external cooling/heating unit for example unit V0019, net weight 2.2 kg

## Circulating Cooling and Heating Unit V0019

Unit for cooling and heating water incl. a circulating pump. Temperature range 0..65 °C, Deviation better then 0.2 K, digital temperature control unit with digital LED display, air cooling, cooling power 300W at 20°C, heating power 1.0 kW, circulation pump rate max. 18 l/min, max. pumping height 3mWS, RS232 interface, touch-screen, main power 1.2 kW, wxdxh 35x44x53 cm, net weight 25,3 kg



## Shear Stress Controlled Drive V0006

Shearstress controlled measurement. You can run torque ramps ore torque-steps, angel-ramps or angel-steps. The torque is measured with a resolution of 0.1 Nmm. The angel is measured with an resolution of 0.01°. Internal resolution 0.001°

## Oscillation-Mode for the Viskomat NT V0030

Oscillation mode: max. amplitude 3.6°, max. frequency 5 Hz. Hint: the standard probes are not symmetric